

**38SL - SLIP ON FLANGE**

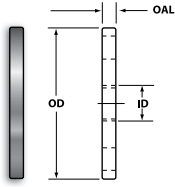

**38SL SLIP ON FLANGE**

-E- DIA THRU (-F-) PLCS  
 ON-G-B.C.

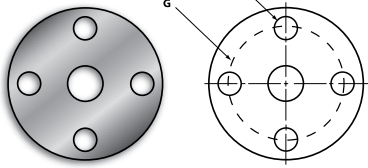

Size A (in.)	O.D. (in.)	I.D. (in.)	E (in.)	F (in.)	G (in.)	OAL (in.)
.500	3.500	.570	.625	4	2.375	.375
.750	3.875	.813	.625	4	2.750	.375
1.000	4.250	1.063	.625	4	3.125	.375
1.250	4.620	1.313	.625	4	3.500	.375
1.500	5.000	1.563	.625	4	3.875	.375
2.000	6.000	2.063	.750	4	4.750	.438
2.500	7.000	2.563	.750	4	5.500	.438
3.000	7.500	3.063	.750	4	6.000	.438
4.000	9.000	4.063	.750	8	7.500	.500
5.000	10.000	5.063	.875	8	8.500	.500
6.000	11.000	6.063	.875	8	9.500	.563
8.000	13.000	8.063	.875	8	11.75	.563
10.00	16.000	10.063	1.00	12	14.25	.688
12.00	19.000	12.063	1.00	12	17.00	.688

For use with 14VB Stub End.

**38 - BLIND FLANGE**

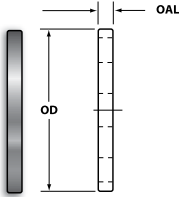

**38 BLIND FLANGE**

-E- DIA THRU (-F-) PLCS  
 ON-G-B.C.

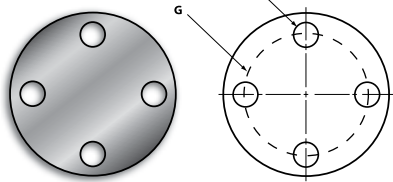

Size A (in.)	O.D. (in.)	I.D. (in.)	E (in.)	F (in.)	G (in.)	OAL (in.)
.500	3.500	.625	4	2.375	.375	.375
.750	3.875	.625	4	2.750	.375	.375
1.000	4.250	.625	4	3.125	.375	.375
1.250	4.620	.625	4	3.500	.375	.375
1.500	5.000	.625	4	3.875	.375	.375
2.000	6.000	.750	4	4.750	.438	.438
2.500	7.000	.750	4	5.500	.438	.438
3.000	7.500	.750	4	6.000	.438	.438
4.000	9.000	.750	8	7.500	.500	.500
5.000	10.000	.875	8	8.500	.500	.500
6.000	11.000	.875	8	9.500	.563	.563
8.000	13.000	.875	8	11.75	.563	.563
10.00	16.000	1.00	12	14.25	.688	.688
12.00	19.000	1.00	12	17.00	.688	.688