

PNEUMATIC ACTUATORS

62, 63, 64, 65, 66 AND 69 MODELS

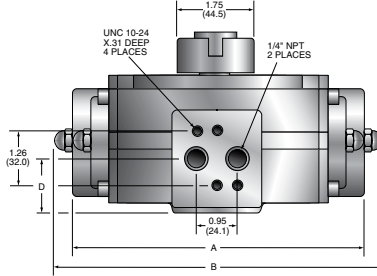
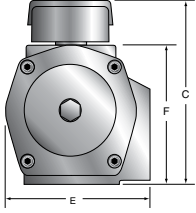

Part No.	A (in.)	B (in.)	C		D (in.)	E (in.)	F (in.)
			Single Mount (in.)	Dual Mount (in.)			
62AD	6.26	-	4.17	3.15	1.26	2.91	3.15
62AC/O	-	6.77	4.17	3.15	1.26	2.91	3.15
63AD	7.09	-	4.68	3.86	1.32	3.39	3.66
63AC/O	-	8.03	4.68	3.86	1.32	3.39	3.66
ADX64	6.34	-	5.00	3.98	1.69	4.27	3.98
ACX64	-	7.17	5.00	3.98	1.69	4.27	3.98
65AD	7.83	-	5.15	4.13	1.54	3.86	4.13
65AC/O	-	9.8	5.15	4.13	1.54	3.86	4.13
66AD	8.70	-	5.67	4.65	1.59	4.25	4.65
66AC/O	-	10.51	5.67	4.65	1.59	4.25	4.65
69AD	11.14	-	6.65	5.63	1.99	5.04	5.63
69AC/O	-	14.17	6.65	5.63	1.99	5.04	5.63