

**General Description:** Parker UHP products are designed as leak-free components for applications where ultra-high pure applications are required. MiniButtweld™ fittings provide compact ultra-high pure designs for use with orbital weld equipment. Their unique machining and surface enhancement prevent outgassing and inhibit corrosion.

- Features:**
- 316L VIM/VAR Material
  - Permanently Heat Code marked; traceable to original mill certificate of test.
  - Electropolished components permanently marked with designator on cube (PE).
  - Critical surfaces are 100% visually inspected using magnification and lighting.
  - Material composition printed on bag.

**MiniButtweld™ FITTINGS**

**SPECIFICATIONS:**

- **Pressure Ratings** will be governed by the tubing selected for a particular application. Working Pressures are calculated below for tubing using maximum allowable stress levels in accordance with ASME/ANSI B31.3, at ambient temperature.
- **Dimensions** are for reference only and are subject to change.

Tube O.D.	Pressure Rating (psig)	Normal Wall Thickness
1/8 in.	8500	.028 in.
1/4 in.	5100	.035 in.
3/8 in.	3300	.035 in.
1/2 in.	3500	.049 in.
6mm	6600	1mm

- **Internal Surface Finishes:** Standard finish MiniButtweld™ fittings have an internal Surface Roughness of 15 µinch Ra. Electropolished (PE) MiniButtweld™ fittings have an internal Surface Roughness of 5µinch Ra.
- **Cleaning and Packaging:** Ultra-High Purity 'OMEGA' cleaning and packaging in a Class 100 Clean Room environment validated per Federal Standard 209E, is standard for all electropolished components.

**MATERIALS:**

- 316L VIM/VAR Material complies with ASTM A276 and ASME SA479. Recommended tubing specifications include ASME SA213, ASTM A213, ASTM A249, ASTM A269, MIL T8504, and MIL T8506.



**MiniButtweld™ FITTINGS**

**REDUCING UNION**

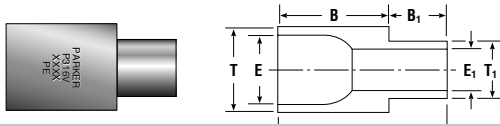

T Tube O.D.	T1 Tube O.D.	Part No.	A (in.)	B (in.)	B1 (in.)	E (in.)	E1 (in.)
1/4	1/8	4-2 MHM-SSV .035 .028	0.75	0.50	0.25	0.18	0.07
3/8	1/4	6-4 MHM-SSV .035	0.75	0.50	0.25	0.31	0.18
1/2	1/4	8-4 MHM-SSV .049 .035	0.75	0.50	0.25	0.40	0.18
1/2	3/8	8-6 MHM-SSV .049 .035	0.75	0.50	0.25	0.40	0.31

**UNION TEE**

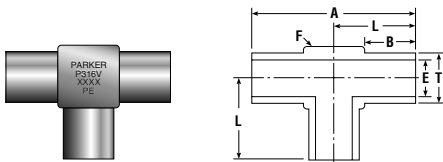

T Tube O.D.	Part No.	A (in.)	B (in.)	E (in.)	F Body Cube	L (in.)
1/8	2-2-2 MJM-SSV .028	0.82	0.25	0.07	5/16	0.41
1/4	4-4-4 MJM-SSV .035	0.82	0.25	0.18	5/16	0.41
3/8	6-6-6 MJM-SSV .035	0.94	0.25	0.31	7/16	0.47
1/2	8-8-8 MJM-SSV .049	1.06	0.25	0.40	9/16	0.53
6 mm	6M-6M-6M MJM-SSV	0.82	0.25	0.16	5/16	0.41

**REDUCING TEE**

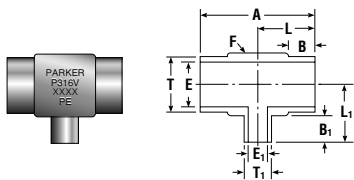

T Tube O.D.	T1 Tube O.D.	Part No.	A (in.)	B (in.)	B1 (in.)	E (in.)	E1 (in.)	F Body Cube	L (in.)	L1 (in.)
3/8	1/4	6-6-4 MJM-SSV .035	0.94	0.25	0.25	0.31	0.18	7/16	0.47	0.47
1/2	1/4	8-8-4 MJM-SSV049049035	1.06	0.25	0.25	0.40	0.18	9/16	0.53	0.53
1/2	3/8	8-8-6 MJM-SSV049049035	1.06	0.25	0.25	0.40	0.31	9/16	0.53	0.53