

**UltraSeal™ TO COMPRESSION TUBE UNION**

**SERIES QHBZ/QHLZ**

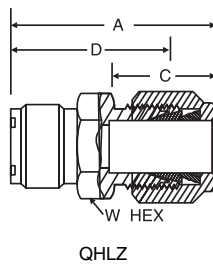
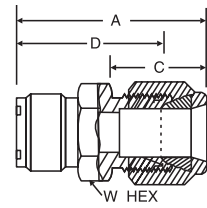

Part No.	Tube O.D. (in.)	W Hex (in.)	C (in.)	A (in.)	D (in.)
4-4 QHBZ (CPI™)	1/4	5/8	.70	1.42	1.13
6-4 QHBZ	1/4	13/16	.70	1.45	1.16
6-6 QHBZ	3/8	13/16	.76	1.51	1.22
8-4 QHBZ	1/4	15/16	.70	1.48	1.19
8-6 QHBZ	3/8	15/16	.76	1.55	1.25
8-8 QHBZ	1/2	15/16	.87	1.65	1.25
12-12 QHBZ	3/4	1-3/8	.87	1.89	1.49
4-4 QHLZ (A-LOK®)	1/4	5/8	.70	1.42	1.13
6-4 QHLZ	1/4	13/16	.70	1.45	1.16
6-6 QHLZ	3/8	13/16	.76	1.51	1.22
8-4 QHLZ	1/4	15/16	.70	1.48	1.19
8-6 QHLZ	3/8	15/16	.76	1.55	1.25
8-8 QHLZ	1/2	15/16	.87	1.65	1.25
12-12 QHLZ	3/4	1-3/8	.87	1.89	1.49

**UltraSeal™ BODY MINIBUTTWELD**

**SERIES QHM**

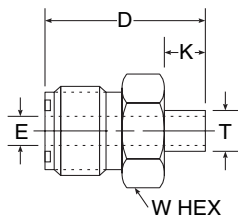

Part No.	T (in.)	D (in.)	K (in.)	*E Bore (in.)	W Hex (in.)
4-4 QHM .035	.25	1.00	.25	.18	5/8
6-6 QHM .035	.38	1.03	.25	.25	15/16
8-8 QHM .049	.50	1.00	.25	.31	15/16

\*Note: Machined Bore diameters to match machined Bore in body.