

**HOW TO ORDER**

Parker UltraSeal™ components are ordered by part number, as listed in this catalog.  
 Note: Each component must be ordered separately.

**Nomenclature:** UltraSeal™ coupler part numbers are constructed from symbols that identify the size and configuration of the fitting and material used.

**Example:** If your system requires an UltraSeal™ coupler going from 1/4" tubing to 1/4" tubing, you would order the following part. (Keep in mind that you must order each component separately.)

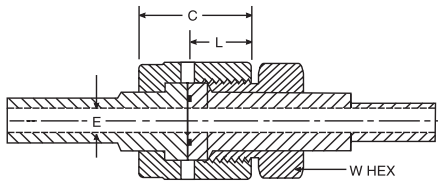
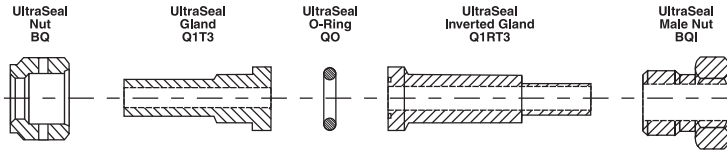

**UltraSeal™ END DATA INFORMATION**

Size	UltraSeal™ Straight Thread	L (in.)	**C (in.)	W Hex (in.)	E Dia. (in.)
4	9/16-20	.46	.73	11/16	.18
8	7/8-20	.47	.85	1	.31
12	1-5/16-20	.57	1.05	1-3/8	.50

\*Average Value

\*\* Dimension C is shown in the finger tight position